



YOUR ADVANTAGE

- Ergonomically shaped case design, ideal for wall mounting and desktop applications.
- Bayonet locking technology with snap-in projections – rational and invisible from the outside.
- For 230 V applications, additional security possible with a screw fixing.*
- Available with raised or flat top part for individual installation configuration.
- Flat top part with recessed operating area for the protection of the membrane keyboard.
- Available without or with battery operation. Battery compartment for two 1.5 V AAA batteries available as accessory.
- 2 different bases for differing set-up and installation angles. Practical for wall and desktop applications.

STANDARD COLOUR

Off-white, RAL 9002.
Fine textured surface.

MATERIAL

ABS (UL 94 HB).
For plastic properties, visit us in the Internet or refer to our general catalogue of cases, from page 229.

SERVICE-CENTER

See page 15.



CONVINCING DESIGN, FUNCTIONAL, ERGONOMIC.

The new ART-CASE range of cases is impressive thanks to its unique design concept. Rounded contours give the cases an attractive appearance.

ART-CASES are remarkable for their progressive and elegant design. They open the door to a new dimension in the packaging of electronics.

ART-CASE is equipped with added functional value to offer many different application options.

APPLICATIONS

Ideal for indoor electrical and electronic applications where particular importance is attached to attractive appearance, e.g. for transmission and reception units in building services management systems and building installations. Also in medical technology, computer peripherals, security technology etc.

CONSTRUCTION

Four versions of electronics cases. The top and bottom parts are equipped with screw pillars for PCBs. The holder for the battery compartment (accessory) is located in the bottom part of the case. Covered by the battery compartment cover (versions I and II) or base (versions III and IV).

ASSEMBLY

Case and base installation with bayonet lock which snaps into place in its final position. If required, the top and bottom parts can be secured using a screw (accessory). To prevent unauthorised removal of the base, this can also be secured with a screw (accessory).



ART-CASE 110 F/H



Detailed drawing available on demand in dwg, dxf or pdf format.

Top parts

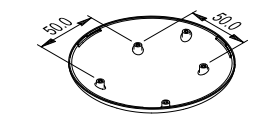
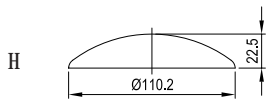
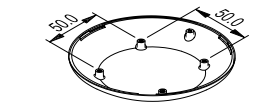
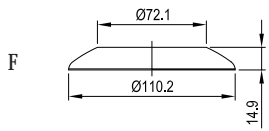

Bottom part "flush"

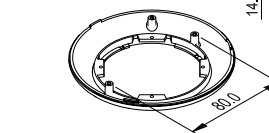
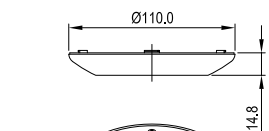

Bottom part "desk"

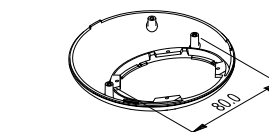
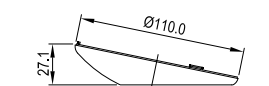

Base 30°

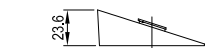

Base 60°

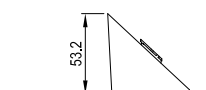

Article	Version / Application
Battery compartment	off-white, for 2 x 1.5 V micro cells (AAA), incl. assembly kit
Set of battery clips	tin plated, for 2 x 1.5 V micro cells (AAA)
Battery contact	tin plated, for a serial connection when using the set of battery clips (acc.)
Battery holder	clamps down securely 2 x AAA*
Self-tapping screw	for additional screw fixing of top and bottom part**, 1 piece
Set of screws	for mounting PCBs, base or batt. comp. lid fixing, ø 2.5 x 6 mm, 4 pcs/set

VERSION I

Bottom part "flush" with battery compartment cover.

Part-No.	
F	H
30 mm high	38 mm high
B 50 11 007	B 50 11 107

VERSION II

Bottom part "desk" with battery compartment cover.

Part-No.	
F	H
38 mm high	41 mm high
B 50 11 207	B 50 11 307

VERSION III

Bottom part "desk" and base for 30° inclination.

Part-No.	
F	H
63 mm high	63 mm high
B 50 11 407	B 50 11 507

VERSION IV

Bottom part "desk" and base for 60° inclination.

Part-No.	
F	H
95 mm high	95 mm high
B 50 11 607	B 50 11 707

ACCESSORIES

Part-No.
B 51 11 107
A 91 66 001
A 91 66 002
A 91 66 003
A 51 14 031
A 91 99 008

* Only necessary when using base versions III and IV with battery compartment (acc.).

** If required, additional screwed attachment of top and bottom parts is possible, either from the back or from the front. Additional machining (drilling) is necessary.