

Разъемы серии IDC на шлейф шаг 2,00мм



Specifications:

Contact Resistance: 30m Ω max.at DC 100 mA
 Insulator Resistance: 1000M Ω min.at DC 500V
 Current Rating: 1AMP

Dielectric Withstanding

Voltage: AC 500V For 1 minute
 Operating Temperature: -55° C--+105° C
 Contact: Phosphor Bronze
 Housing: PBT &30% Glass Fiber(UL 94V-0)

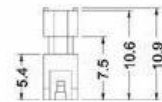
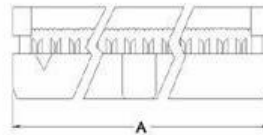
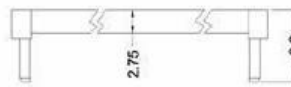
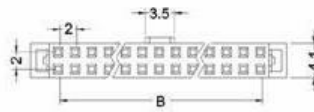

Position	A	B	Position	A	B
8	13.2	6.0	30	35.2	28.0
10	15.2	8.0	34	39.2	32.0
14	19.2	12.0	40	45.2	38.0
16	21.2	14.0	44	49.2	42.0
20	25.2	18.0	50	55.2	48.0
24	29.2	22.0	60	65.2	58.0
26	31.2	24.0	64	69.2	62.0

Разъёмы серии IDC на шлейф шаг 2,54мм.

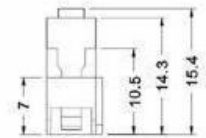
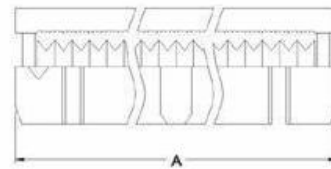
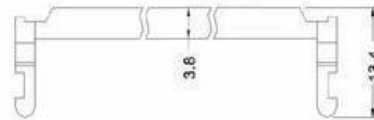
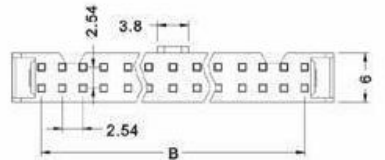

Specifications:

Contact Resistance: 30mΩ max.at DC 100 mA
 Insulator Resistance: 1000MΩ min.at DC 500V
 Current Rating: 1AMP

Dielectric Withstanding

Voltage: AC 500V For 1 minute
 Operating Temperature: -55° C--+105° C
 Contact: Phosphor Bronze
 Housing: PBT &30% Glass Fiber(UL 94V-0)

Position	A	B	Position	A	B
8	14.73	7.62	30	42.67	35.56
10	17.27	10.16	34	47.75	40.64
14	22.35	15.24	40	55.37	48.26
16	24.89	17.78	50	68.07	60.96
20	29.97	22.86	60	80.77	73.66
26	37.59	30.48	64	85.85	78.74

Разъемы FDC вилка на шлейф, шаг 2,54мм.



Specifications:

Contact Resistance: 30mΩ max.at DC 100 mA
 Insulator Resistance: 1000MΩ min.at DC 500V
 Current Rating: 1AMP

Dielectric Withstanding

Voltage: AC 500V For 1 minute
 Operating Temperature: -55 ° C--+105 ° C
 Contact: Phosphor Bronze
 Housing: PBT &30% Glass Fiber(UL 94V-0)

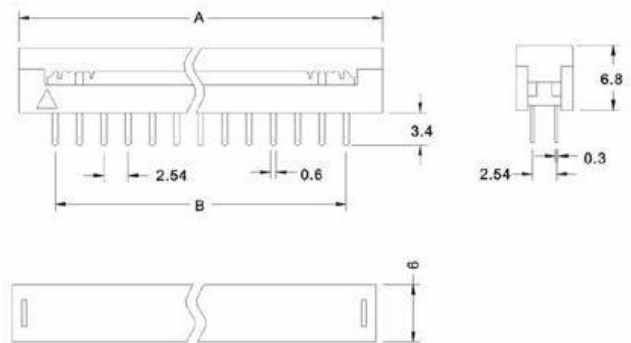

Position	A	B	Position	A	B
10	17.80	10.16	34	48.40	40.64
14	22.82	15.24	40	55.92	48.26
16	25.40	17.78	50	68.72	60.96
20	30.52	22.86	60	81.42	73.66
26	38.12	30.48	64	86.38	78.74
30	43.32	35.56			